



Roadster Lounge Chair

Assembly Guide

SKIN+ACT

Need Additional Help? Contact Us: info@skinact.com

Parts List:

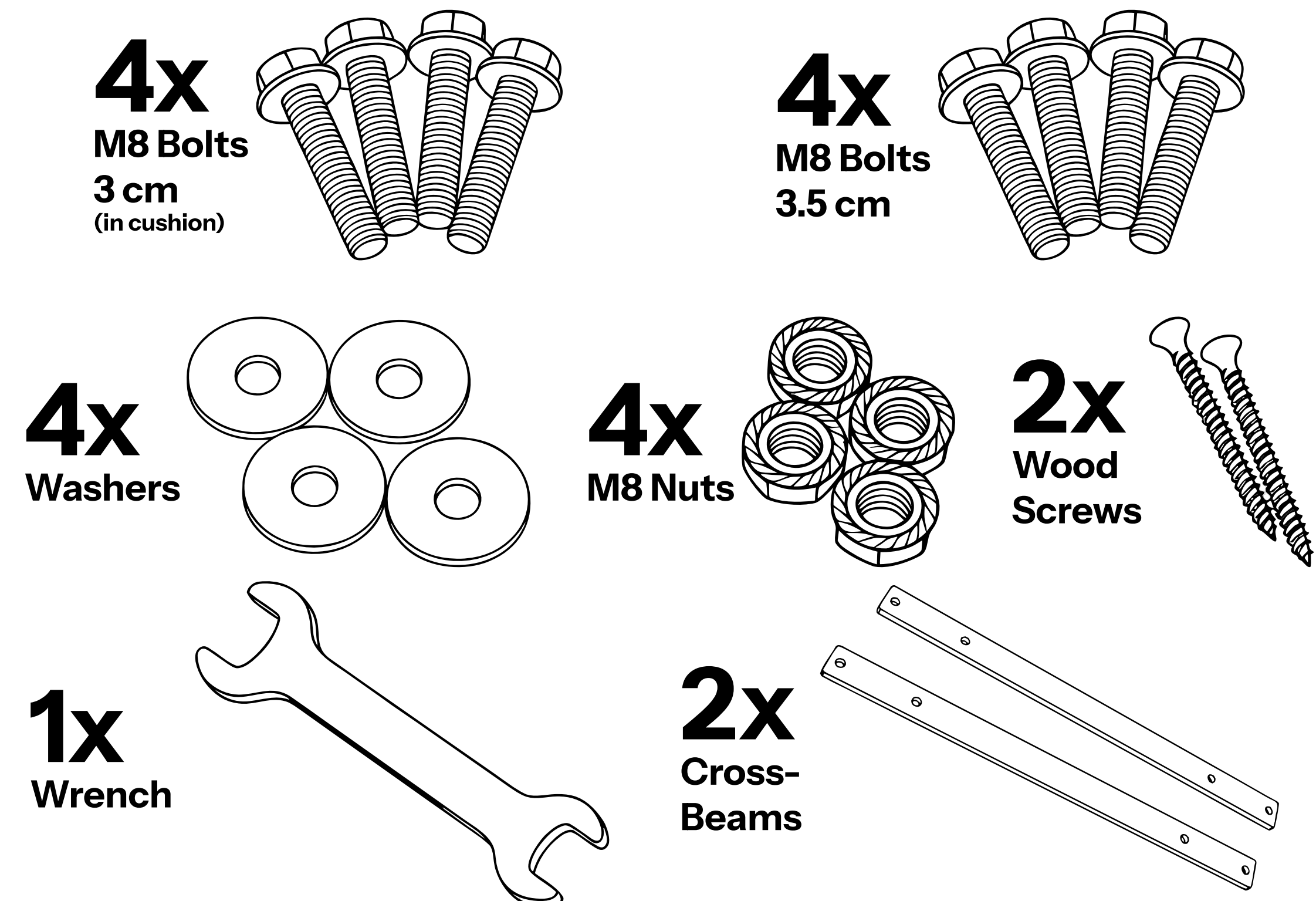
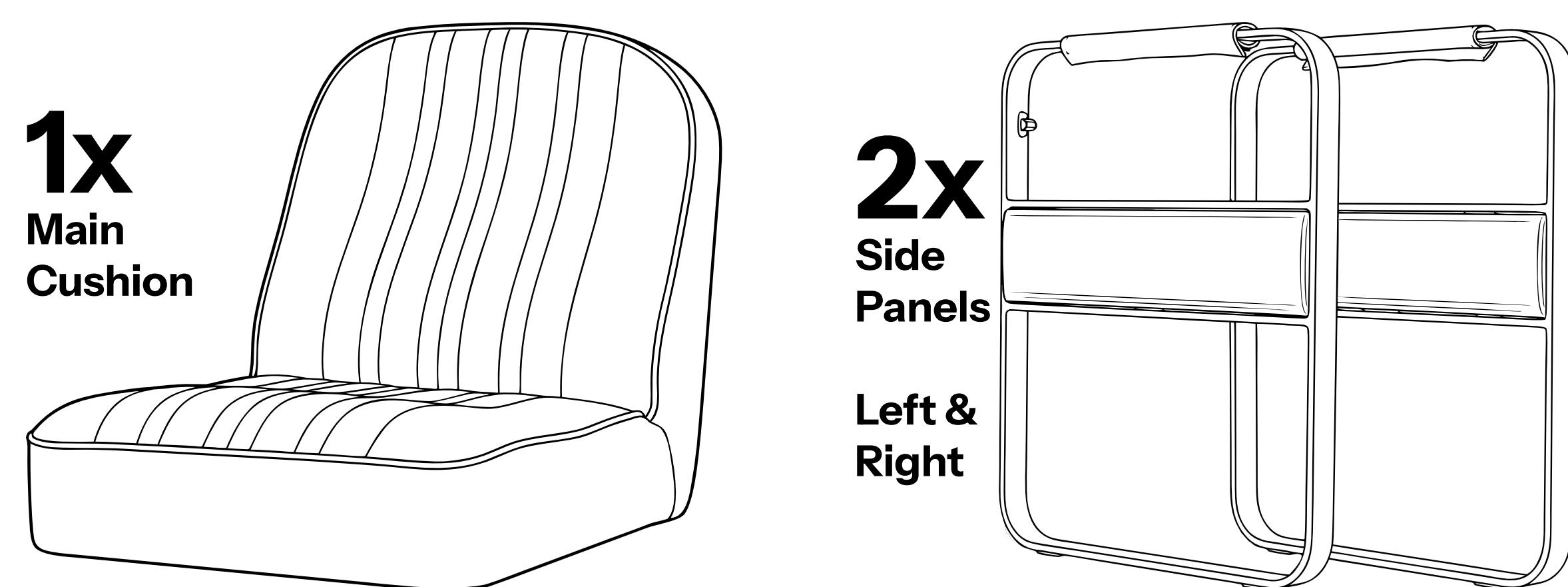

1 Remove bolts from the bottom of the main cushion.

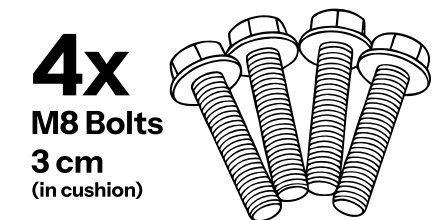
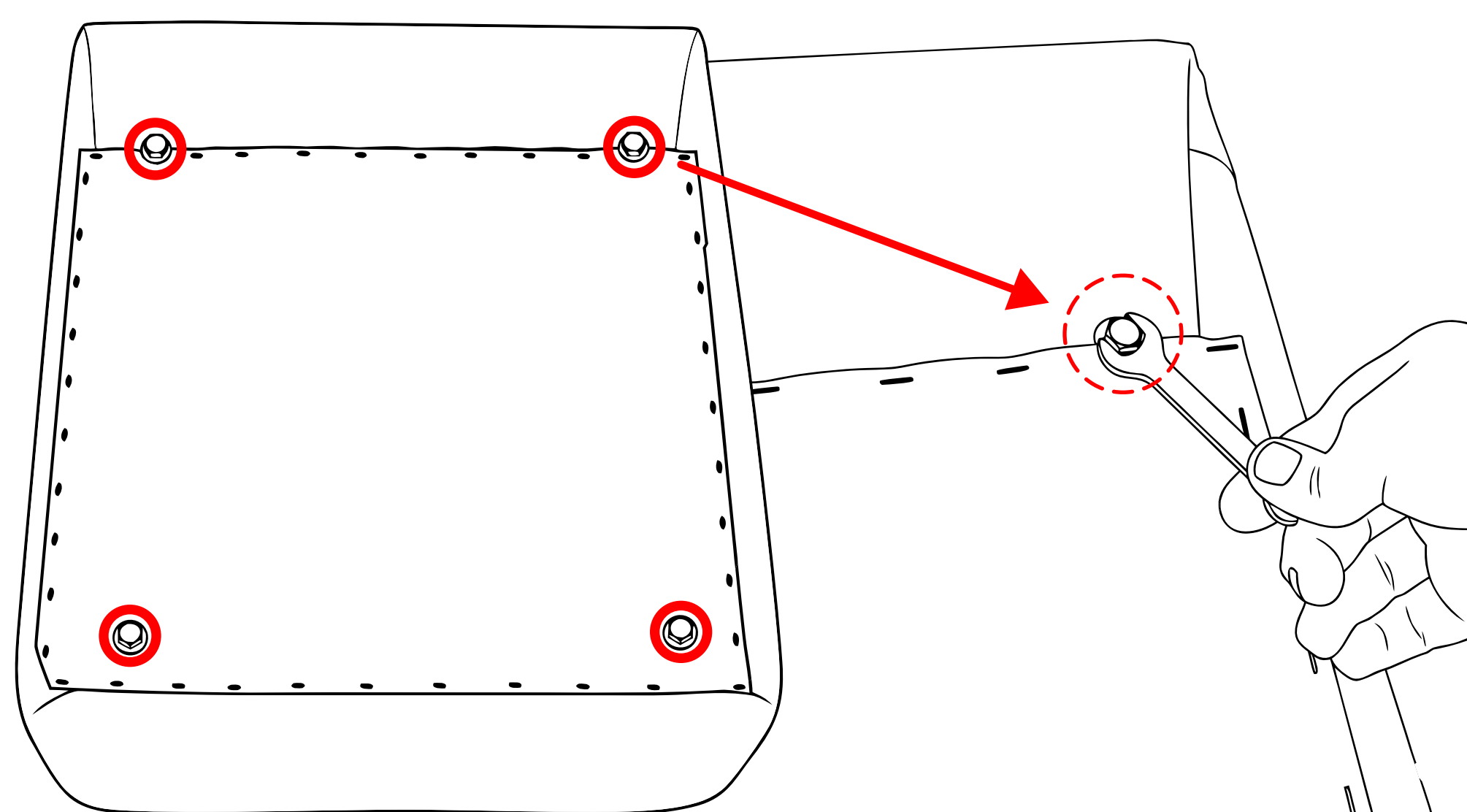

2 Attach one end of the cross-beam to the side panels, on the inner part. Secure using long bolt and washer.

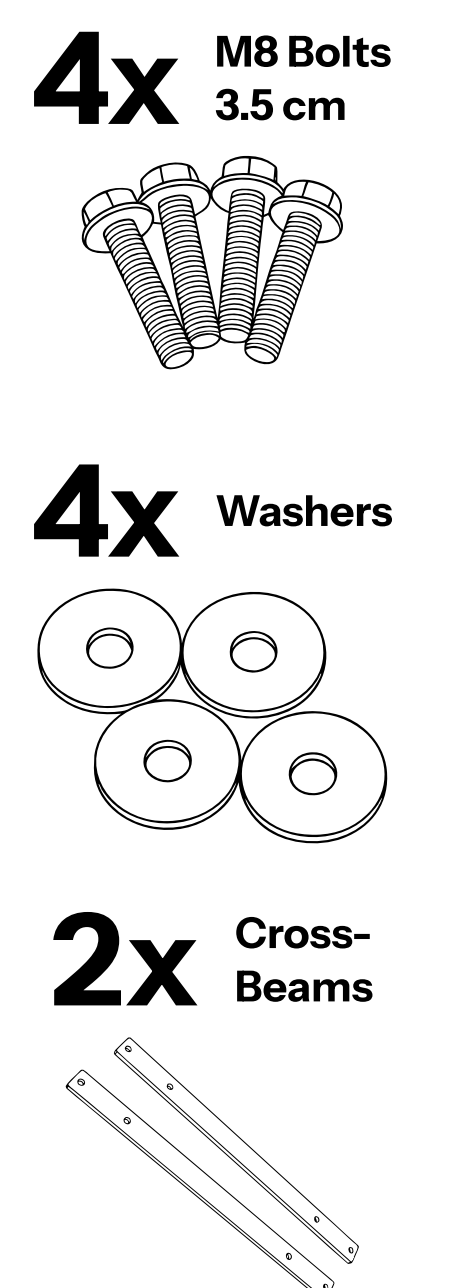
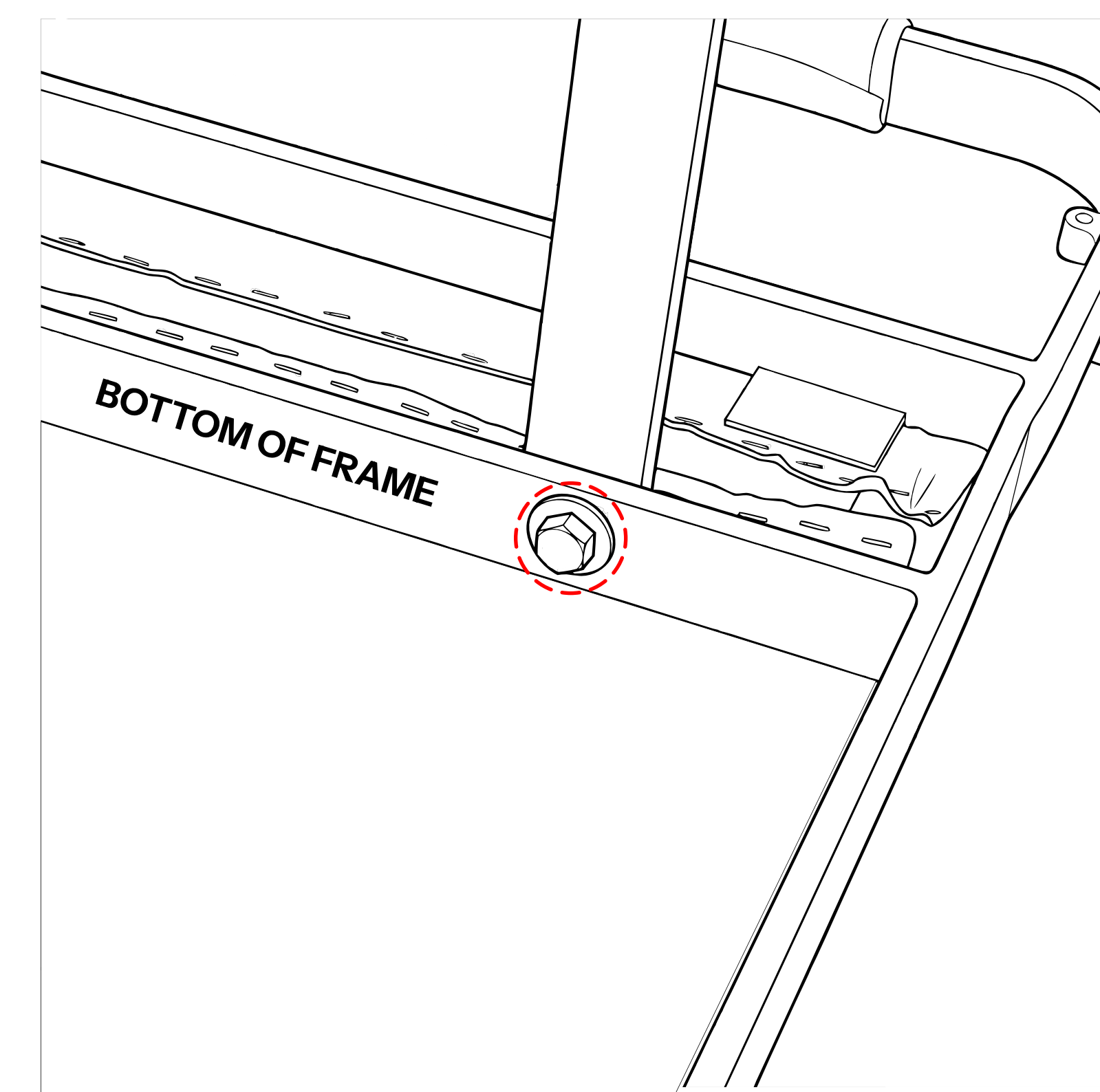

3 Tighten the nut and bolt using the provided wrench.

Repeat 4 times to build the frame.

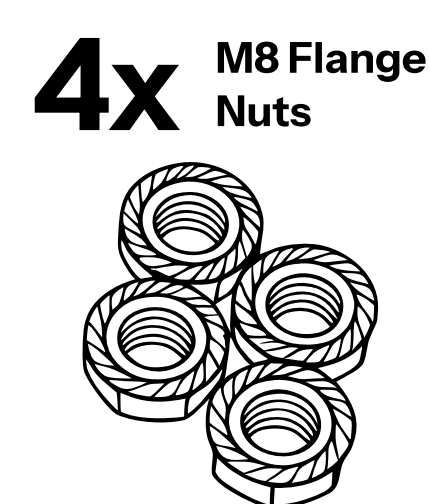
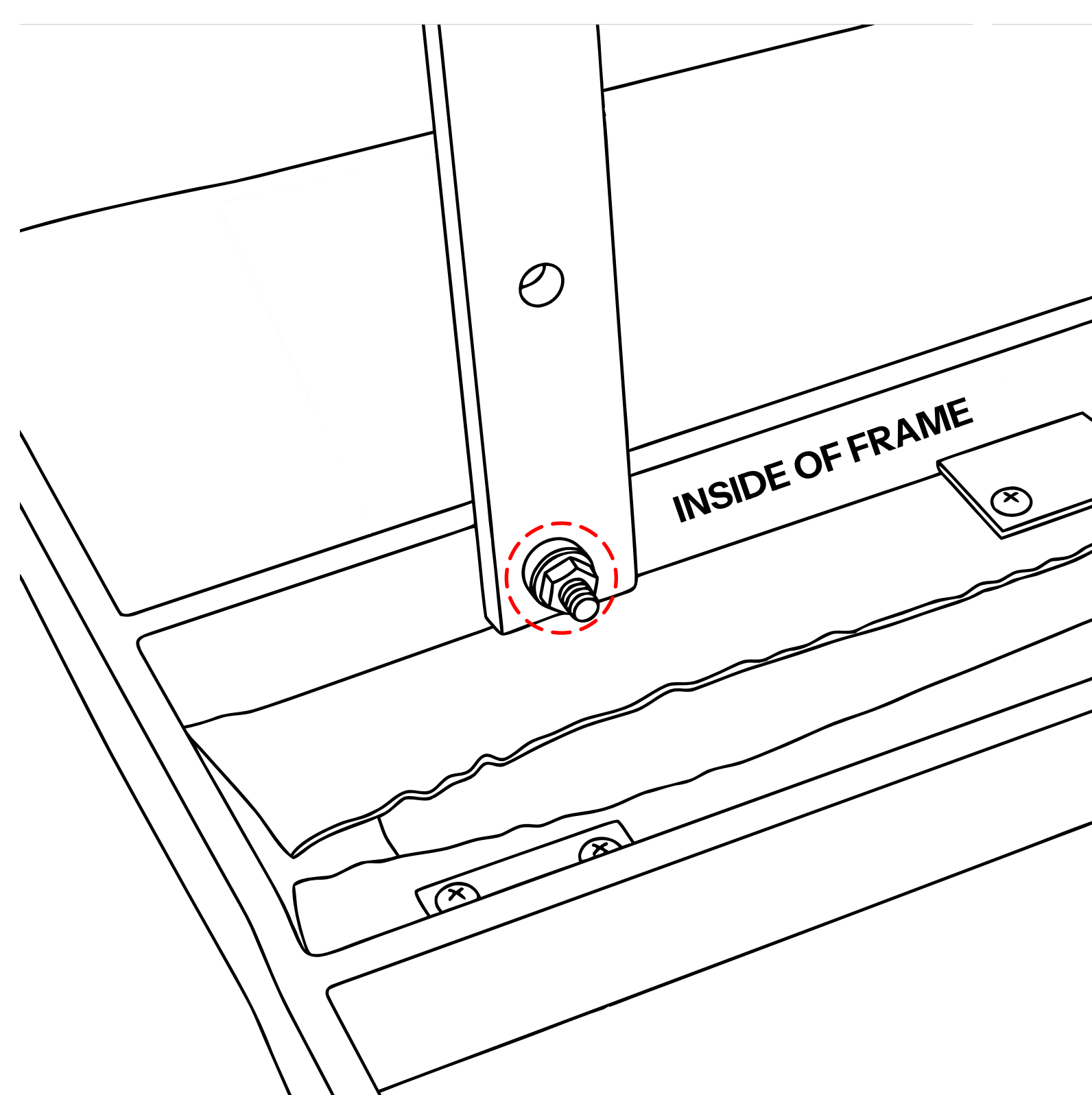

4 Place main cushion into frame and line up bolt holes with cross-beam holes.

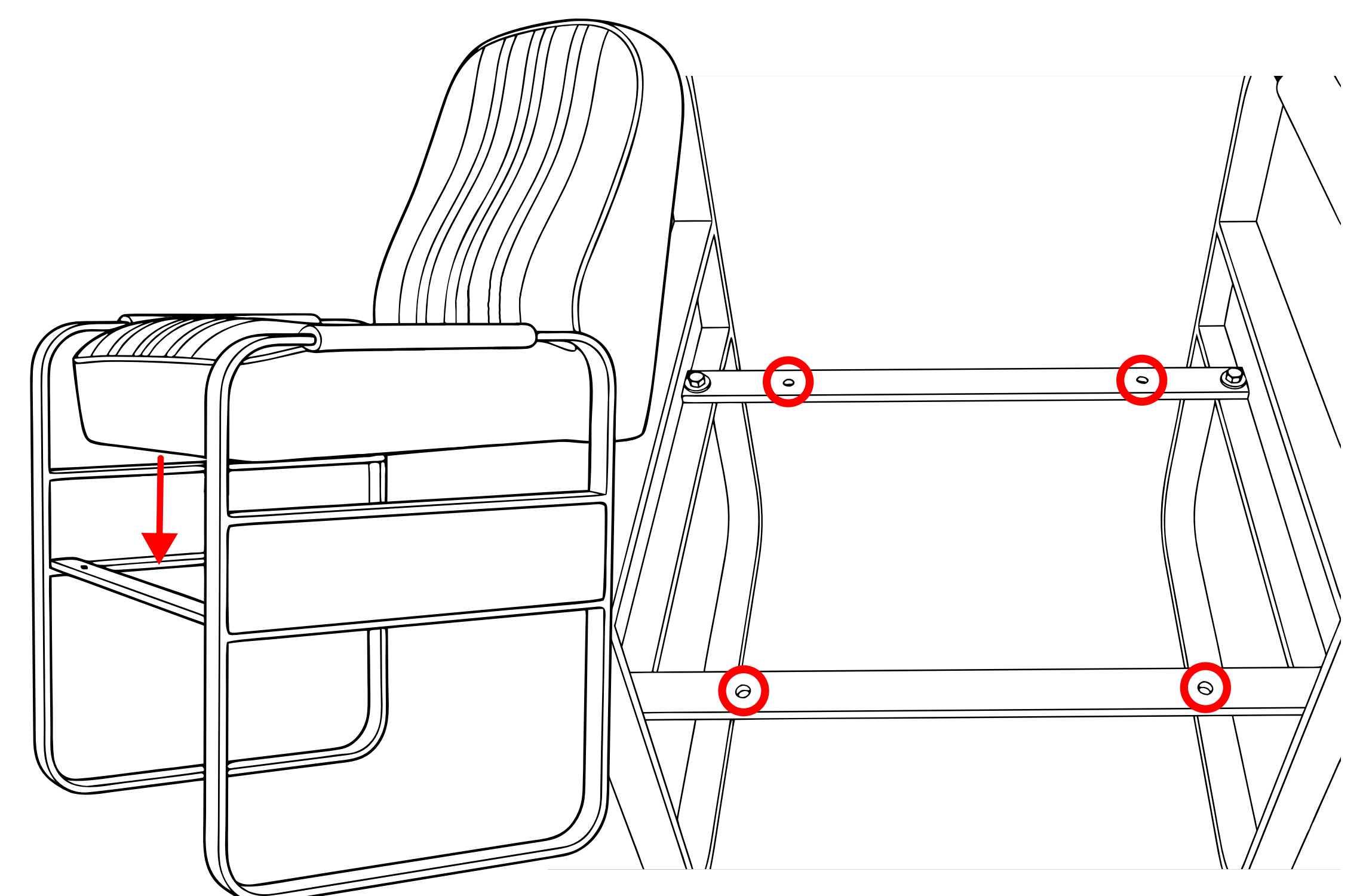

5 Secure short bolts (removed from the cushion in step 1) into main cushion using the provided wrench.

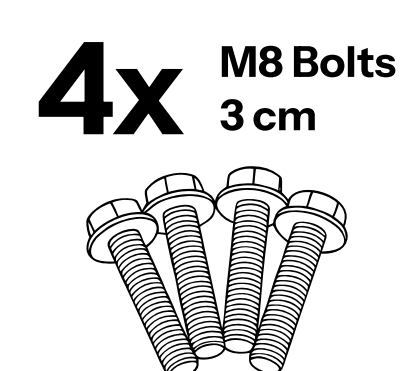
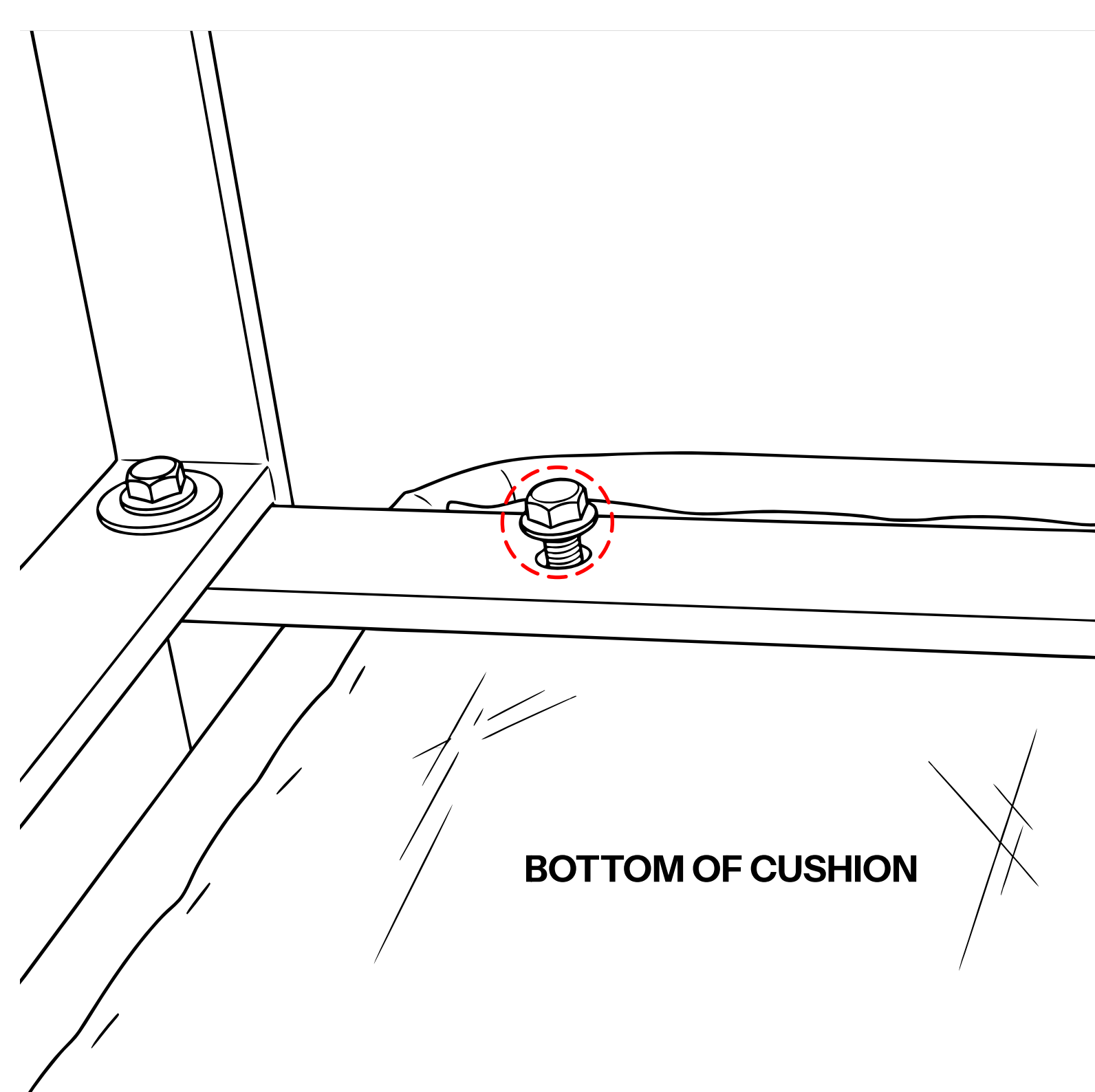

6 Fasten wood screw into the side hole of the frame to secure the chair to the frame.

