

Basic Facial Chair/Table User Manual



SKIN+ACT

Toll Free: 1.800.418.0830

www.skinact.com
www.spaandequipment.com

International: 818.834.6640

NOTICE

No part of this document may be photocopied, reproduced, or translated into any other language without prior written consent of Spa and Equipment/SkinAct.

The information in this document is subject to change without notice at any time and should not be construed as a commitment by Spa and Equipment/SkinAct.

Spa and Equipment/SkinAct assumes no responsibility for any errors that may be in this document, nor does it make expressed or implied warranty with regard to this material, including, but not limited to, the implied warranties of merchantability and fitness for a particular purpose.

Spa and Equipment/SkinAct shall not be liable for incidental or consequential damages arising out of the furnishing, performance, or use of this document and the program material which it describes.

SKIN+ACT

Toll Free: 1.800.418.0830	www.skinact.com www.spaandequipment.com	International: 818.834.6640
---------------------------	--	-----------------------------

Precautions

- Read this manual carefully before installation and operation.
- No one should ever sit on the foot rest or backrest areas.
- This unit should only be operated by trained professionals.
- Keep children from using or playing on the unit.
- Do not stand on any portion of the unit.
- Ensure the unit is kept dry and free of water.
- When operating the unit, ensure that your and your clients' hands or other body parts cannot be pinched by the moving parts (see pinch points below).
- If you have gone through the troubleshooting steps in this manual and an issue persists, please call Spa and Equipment/SkinAct for further assistance: 1(800)418-0830
- **OPERATE AT YOUR OWN RISK AND USE COMMON SENSE: OWNER/OPERATOR IS RESPONSIBLE FOR HIS/HER OWN SAFETY AS WELL AS ANYONE NEAR OR ON THE UNIT.**

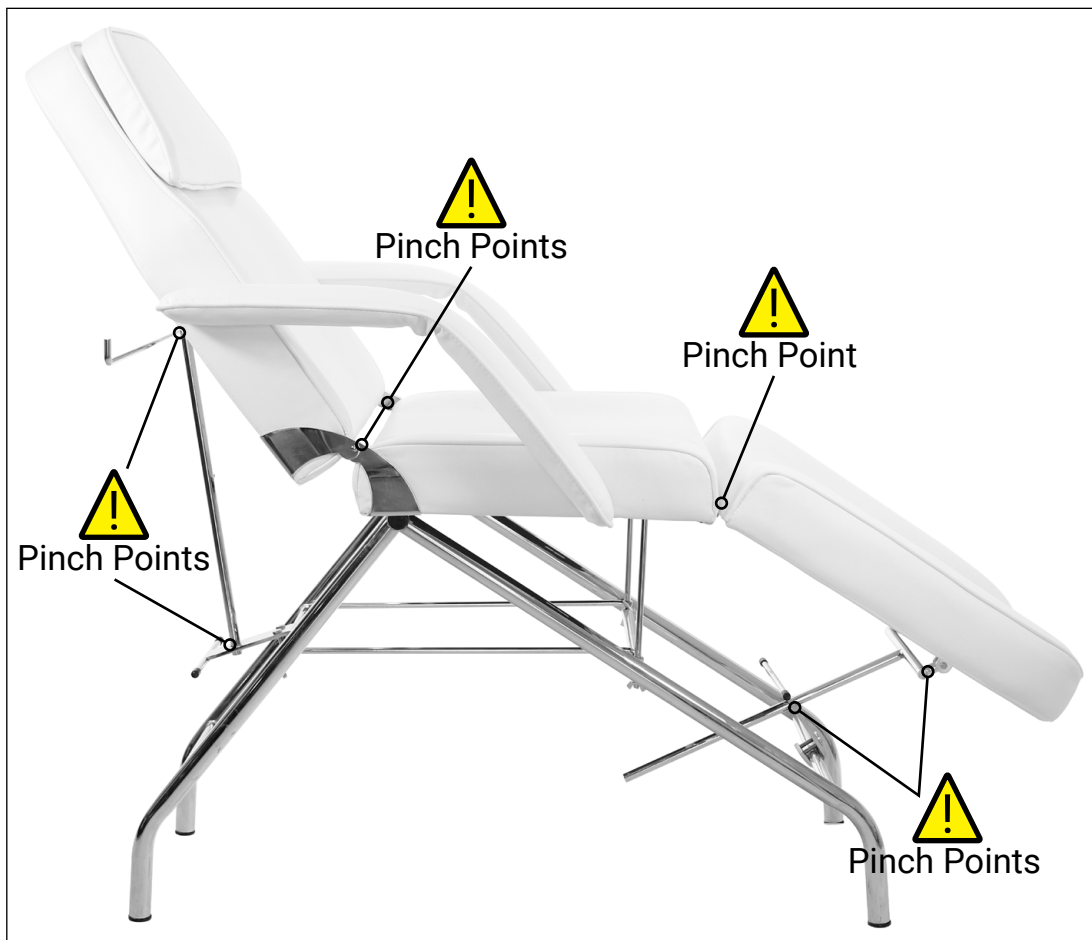

Removing From The Box/Assembly

- **Please keep all original packaging materials.**
- **TEAM LIFT:** Make sure to have at least two people to lift and move the unit.
- If you have a furniture dolly or a pallet jack, you can use one of those to help with moving the box. Otherwise, you and your partner can carry the box into your space.



- Open the top carefully and remove all of the items inside.
- To see an assembly video for this unit, you can visit <https://youtu.be/BGE4aQJqCkE> or scan the QR code below.

Scan for assembly
video



ASSEMBLY INSTRUCTIONS

- Turn the chair over cushion down on a clean work area (see photo on the next page).

Assembly



- Take the two L-shaped rods and remove the wing nuts from the threaded ends.



- Insert the L-shaped rods into their brackets on the bottom of the middle seat cushion. Make sure to insert from the outside as in the photo below. Arrows show insertion direction.

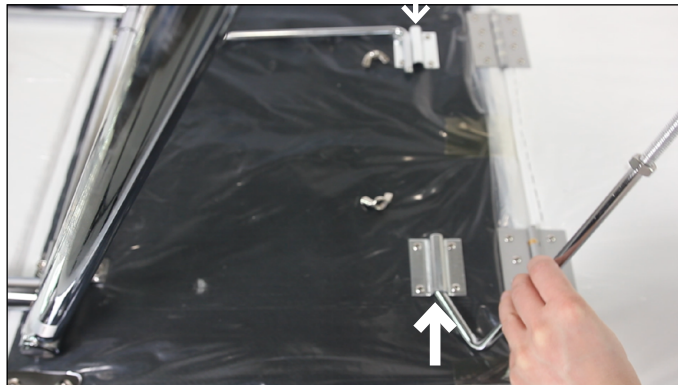

- Lift the metal frame section up and put the threaded ends of the L-shaped rods into their holes on the frame.

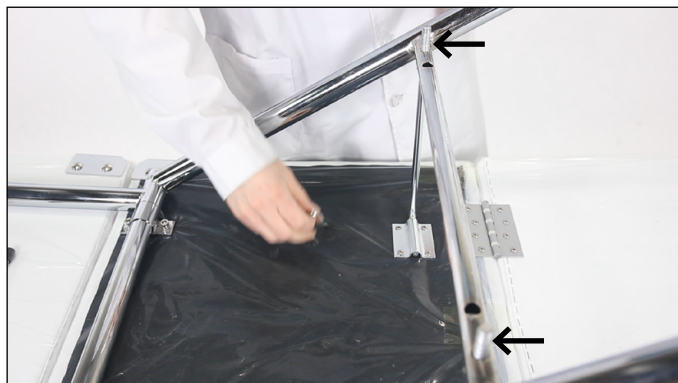

Assembly

- Attach both wing nuts to the threaded ends of the L-shaped rods after the rods are in their holes on the frame.



- Next take both U-shaped rods and remove the wing nuts.



- Ensure the U-shaped rods face this direction. They will insert into their holes as in the photo below.



- Lift the other frame and insert both U-shaped rods into their holes. Reattach the four wing nuts (photo on next page).

Assembly



- Next take the shorter T-shaped rod to the **foot rest** section of the chair.



- Remove the screw at the end of the shorter T-shaped rod. **Do not lose the screw.**

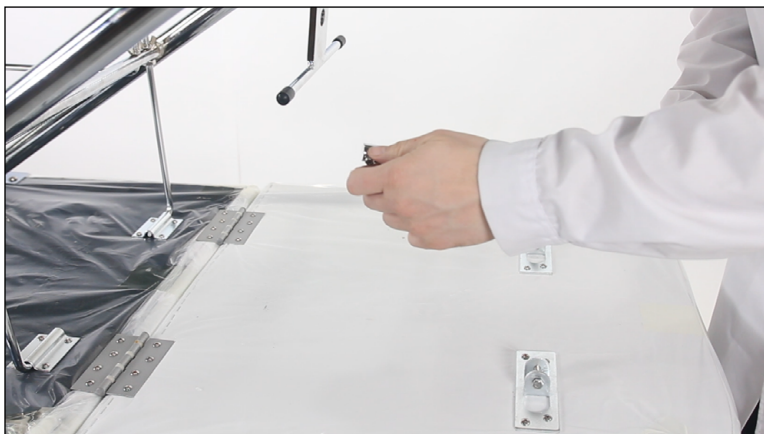

- Insert the rod into the hole on the bracket on the frame (photo on next page).

Assembly



- Undo the nuts and bolts on the two foot rest section brackets (1) & (2).
- Then put the two ends of the T-shaped rod into the foot rest brackets and replace the nuts and bolts (3).
- Tighten the nuts and bolts by hand. Then use two 10mm wrenches for a few turns (4). **Do not overtighten.**

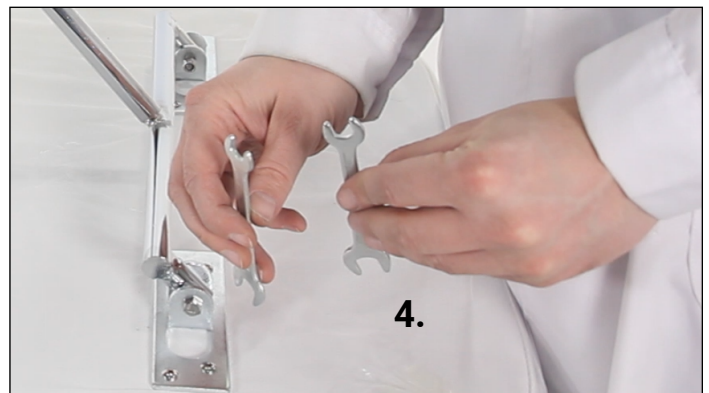
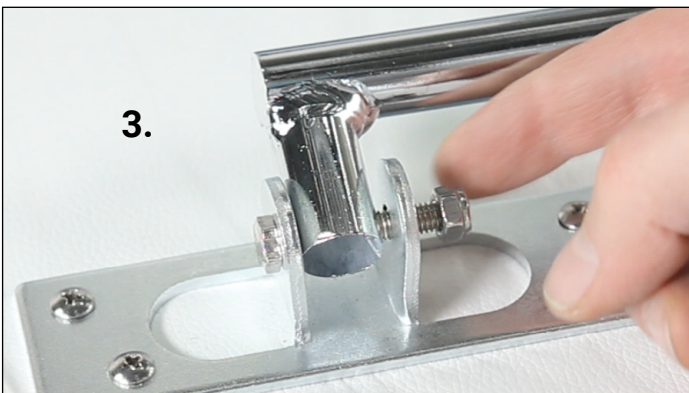
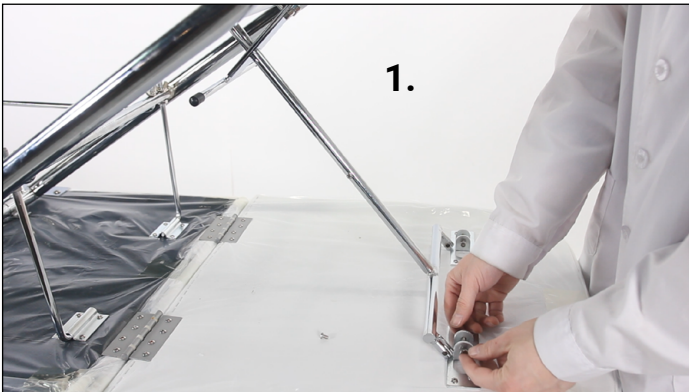

- Finally replace the small screw at the end of the short T-Shaped rod (photo on next page).

Assembly



- The foot rest section is done! **The procedure is exactly the same for the long T-shaped bracket and the backrest section.** Remember to turn the nuts and bolts a few turns with two 10mm wrenches.



- Also, do not forget to put the screw back at the end of the long T-shaped rod.



Assembly

- Next you can attach the table paper holder. This step is very simple. First, unscrew the screw on the short end.

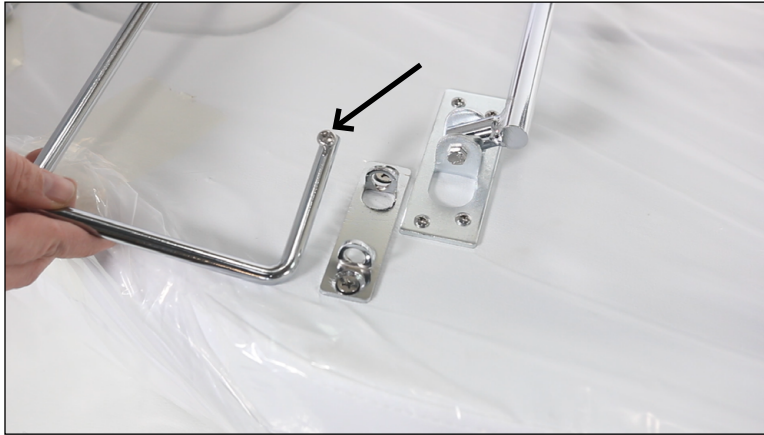

- Insert the table paper holder into its bracket and replace the screw on the short end.



- Use a screwdriver to snug the screw into place. **Do not over-tighten.**



Assembly

- The last things to do are attach the head rest pillow and put the arm rests on.



- For the arm rests, simply insert the rods of the arm rests into the holes and push the arm rests in until they are seated.



- Congratulations! Your chair is now fully assembled and ready for your next treatment.

Measurements

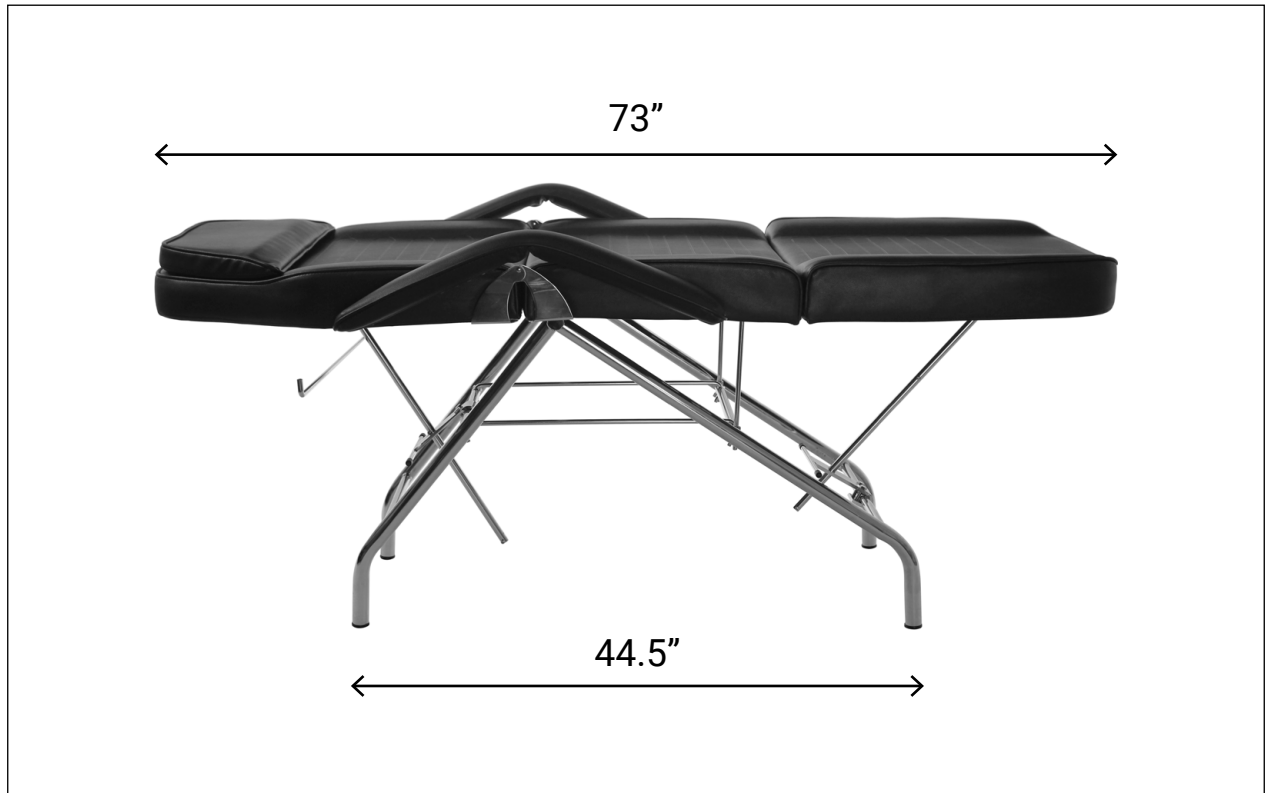

Measurements



Dimensions/Specifications

- Length: 73"
- Width without arm rests: 24.5"
- Width with arm rests: 33"
- Height: 30"
- Base dimensions (BASE ONLY): 44.5" x 20"
- Backrest adjustment from 0° flat to 55° incline
- Leg rest adjustment from 0° flat to 45° decline
- Weight: 69 lbs
- Capacity of 350 lbs
- Cushion thickness: 4"

* All height measurements are from ground to top of cushion

* All measurements have a 0.25 to 0.75 inch tolerance

Maintenance

- When cleaning and sanitizing, **do not use bleach, Barbicide, or other harsh chemicals**. Using harsh chemicals can damage the upholstery.
- Simple Green or upholstery cleaners work great for cleaning the upholstery. We recommend using Lysol Wipes for sanitizing the upholstery.
- Clean and sanitize the upholstery after each treatment.
- Every six months, visually inspect the parts of the unit. If there are any abnormal noises or vibrations during operation, call Spaandequipment/SkinAct and describe the situation.

Troubleshooting

Issue	Possible Reason	Solution
Section(s) loose or wobbly	Fasteners are loose	Check all nuts, bolts, and screws. Tighten any loose ones.
	Broken part(s)	Replace broken part(s).

Warranty

- This item has a 1-year limited warranty for malfunctions and manufacture defects only (parts, labor, and shipping not included). **THIS WARRANTY IS VOID IN THE EVENT EQUIPMENT IS DAMAGED BY IMPROPER USE.**
- To read the full Warranty Policy, please visit <https://www.spaandequipment.com/Return-Warranty-Repair-Policy.html> or scan the QR code below.

Scan for
warranty

